

Lot 18, The Perch Subdivision White Hills

Site Classification
for
JLEJ Investments

Report 18C 0616
August, 2018

Lot 18, The Perch Subdivision, White Hills

Site Classification for JLEJ Investments

Revision

Revision	Date	Authorised
18C 0616 (Lot 18)	29/8/18	SEH

Distribution (this revision only)

Recipient	Format	Date
GTSS	On file	29/8/18
JELJ Investments Attn: Jason Fehring	Email PDF jason.fehring@spiire.com.au	29/8/18

1 INTRODUCTION

JLEJ Investments commissioned Geotechnical Testing Services to conduct a geotechnical investigation for the proposed residential development located at Lot 18, The Perch Subdivision, White Hills.

The investigation has been conducted for the purpose of assessing general subsurface conditions at the site and consequently assigning a Site Classification in accordance with AS2870 – 2011 “Residential Slabs and Footings”.

2 INVESTIGATION

The investigation was conducted by a technician on the 30th of July, 2018 using a vehicle mounted drill-rig and drilling 2 boreholes to depths of 1.5 metres within the designated area. The subsequent soil profiles are presented in page 6 and the location of the boreholes are presented on page 7.

At the time of this investigation, the type of development proposed is unknown to GTS.

3 SITE CONDITIONS

The site has a slight fall to the rear left as looking from the roads and is currently vacant. At the time of the investigation the surface of the site was moist with a sparse covering of natural grass. There are many large trees present along the road reserve. There was visual evidence of surface rock. No groundwater seepage was encountered over the investigated depths.

Full details of soil conditions are presented in the borehole logs.

4 SITE CLASSIFICATION

After allowing due consideration to the site geology, soil conditions, the presence of trees, drainage and known details of the proposed structure, the site has been classified as **Class M** (AS2870 – 2011).

Foundations designed in accordance with this classification are to be subject to the overriding conditions of Section 5 below.

5 DISCUSSION

Particular attention should be paid to the design of footings as required by AS2870 – 2011.

In addition to the normal founding requirements arising from the above classification, particular conditions at the site dictate that the founding medium and minimum depth below existing surface levels for all footings should be as follows:

- Silty CLAY, some gravel, medium plasticity, brown, pale brown, very stiff
At depths below 0.1 metres in the region of BH1
- Gravelly Silty CLAY, medium plasticity, pale brown, stiff
At depths below 0.4 metres in the region of BH2

An allowable bearing pressure of 100kPa is available for edge beams, strips and stump footings founded as above. All foundations should extend a minimum of 100mm into the above founding material.

6 IMPORTANT NOTES ABOUT THIS REPORT

- The site classification presented in Section 4 assumes that the current natural drainage and infiltration conditions at the site will not be markedly affected by the proposed site development work. Care should therefore be taken to ensure that surface water is not permitted to collect adjacent to the structure and that significant changes to seasonal soil moisture equilibria do not develop as a result of service trench construction or tree root action.
- Attention is drawn to Appendix B of AS 2870 and CSIRO document, BTF 18 – “Foundation Maintenance and Footing Performance: A Homeowner’s Guide” as a guide to maintenance requirement for the proposed structure.
- This is not a comprehensive investigation nor is it economic or practical to determine every subsurface feature on the site. Although this investigation indicates that soil conditions are relatively uniform across the site, it is recommended that the base of all footing excavations be inspected to ensure that the founding medium meets that requirements referenced herein with respect to type and strength of founding materials. If further variations in descriptions in soil types, colour or depths are discovered during construction, this office should be notified immediately so that potential influence on the footings may be assessed.
- The soil colours provided in the borelogs attached may vary with soil moisture content and individual interpretation, therefore colour alone should not be used to identify these soils.

- Strength characteristics of soils often exhibit a large variation between wet and dry conditions. Soil characteristics of a soil profile are given on the soil conditions at the time of the investigation.
- In the event of significant earthworks being undertaken on the site after this investigation, this report may require an amendment if appropriate.
- If FILL is found during this investigation, it is an indication of what was found during the investigation and it may vary over the site. It may be in the best interest of the buyer / seller to undertake a more detailed investigation, in this instance.

Should you have any further queries concerning these results, please do not hesitate in contacting this office on 5441 4881



Shane Hampton BE (Hons)
Senior Geotechnical Engineer

Enclosed

Borehole Logs (Page 6)

Site Map (Page 7)

Borehole Logs

Client:	JLEJ Investments	Borehole Log No.:	1-2
		Report Number:	18C 0616
		Date Drilled:	30/7/18
Project:	Lot 18, The Perch Subdivision	Logged By:	TP
		Drilling Method	AS

Profile (mm):	* Structure: (see key)	Material Description:	Moisture Description:	Cohesion Density:	Plasticity:	Testing / Sampling:
0 To 100	Fill	BH1 Gravelly Sandy SILT Dark brown	M	L	-	
To 800	Soil Profile	Silty CLAY Brown, pale brown, some gravel	D	VSt	Medium	
To 1500	Rock	SILTSTONE Extremely weathered, pale brown	D	Soft Rock	-	
0 To 400	Fill	BH2 Gravelly Silty CLAY Dark brown	D	St	Low	
To 600	Soil Profile	Gravelly Silty CLAY Pale brown	D	St	Medium	
To 1500	Rock	SANDSTONE Extremely weathered, yellow/brown	D	M/H	-	

Key:

Drilling Method:	Moisture Condition	Cohesion:	Density:	Testing/Sampling:
AS - Auger Screwing	D - Dry	VS - Very Soft	VL - Very Loose	PP – Pocket Penetrometer
HA - Hand Auger	M - Moist	S - Soft	L - Loose	V – Hand Vane Sheer
	W - Wet	F - Firm	MD - Medium Dense	DCP – Dynamic Cone Penetrometer
		ST - Stiff	D - Dense	SPT – Standard Penetration Test
		VST - Very Stiff	VD - Very Dense	US – Undisturbed Sampling
		H - Hard		DS – Disturbed Sampling
		VH – Very hard		* See notes on borelog location page

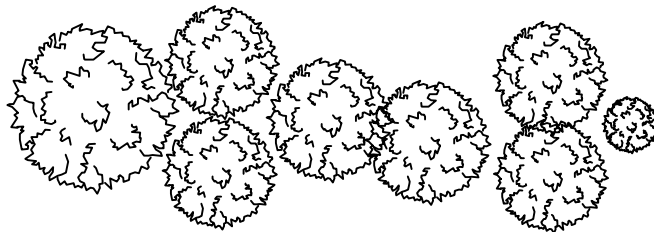
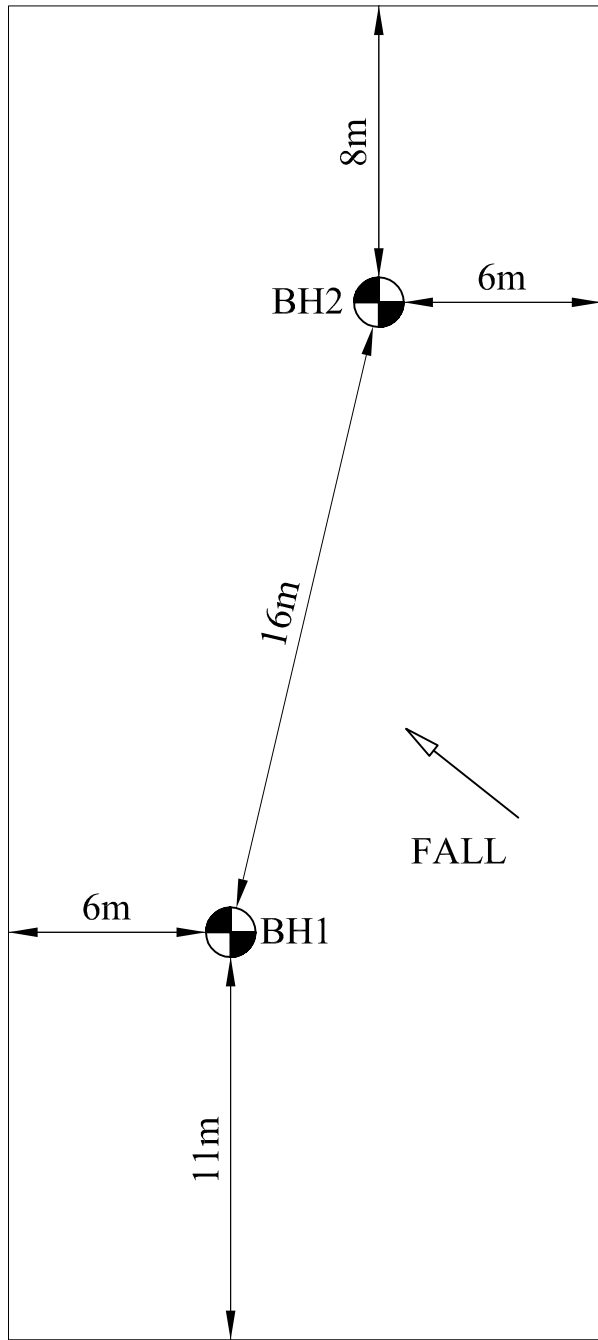

ST KILLIANS STREET